

NOTES: UNLESS OTHERWISE SPECIFIED

- ABBREVIATION USED IN TITLE IS: VALVE REGULATED SEALED LEAD ACID (VRSLA).
- MANUFACTURED AND INSPECTED IAW AS9100 QUALITY SYSTEM REQUIREMENTS.
- SEE DRAWING NUMBER CB-00350 AND PROCEDURE P-1000 FOR ASSEMBLY AND TEST INSTRUCTION. PROCEDURES AND ASSEMBLY DRAWINGS ARE FOR INTERNAL USE ONLY.
- BATTERIES ARE RATED IAW INTERNATIONAL ELECTROTECHNICAL COMMISSION STANDARD 60952-1, AND RTCA STANDARD DO-293, UNLESS OTHERWISE NOTED.
- GENERAL AVIATION BATTERIES ARE NOT DESIGNED FOR REPETITIVE TURBINE ENGINE STARTING.
- USE SPACER, CBC PART NUMBER 9909, AS REQUIRED.

REVISIONS			
REV	DESCRIPTION	DATE	APPROVED
A	REVISED POWER RATINGS AND NOTES	2/17/10	JBT
B	ADDED NOTE 6	10/6/10	JBT

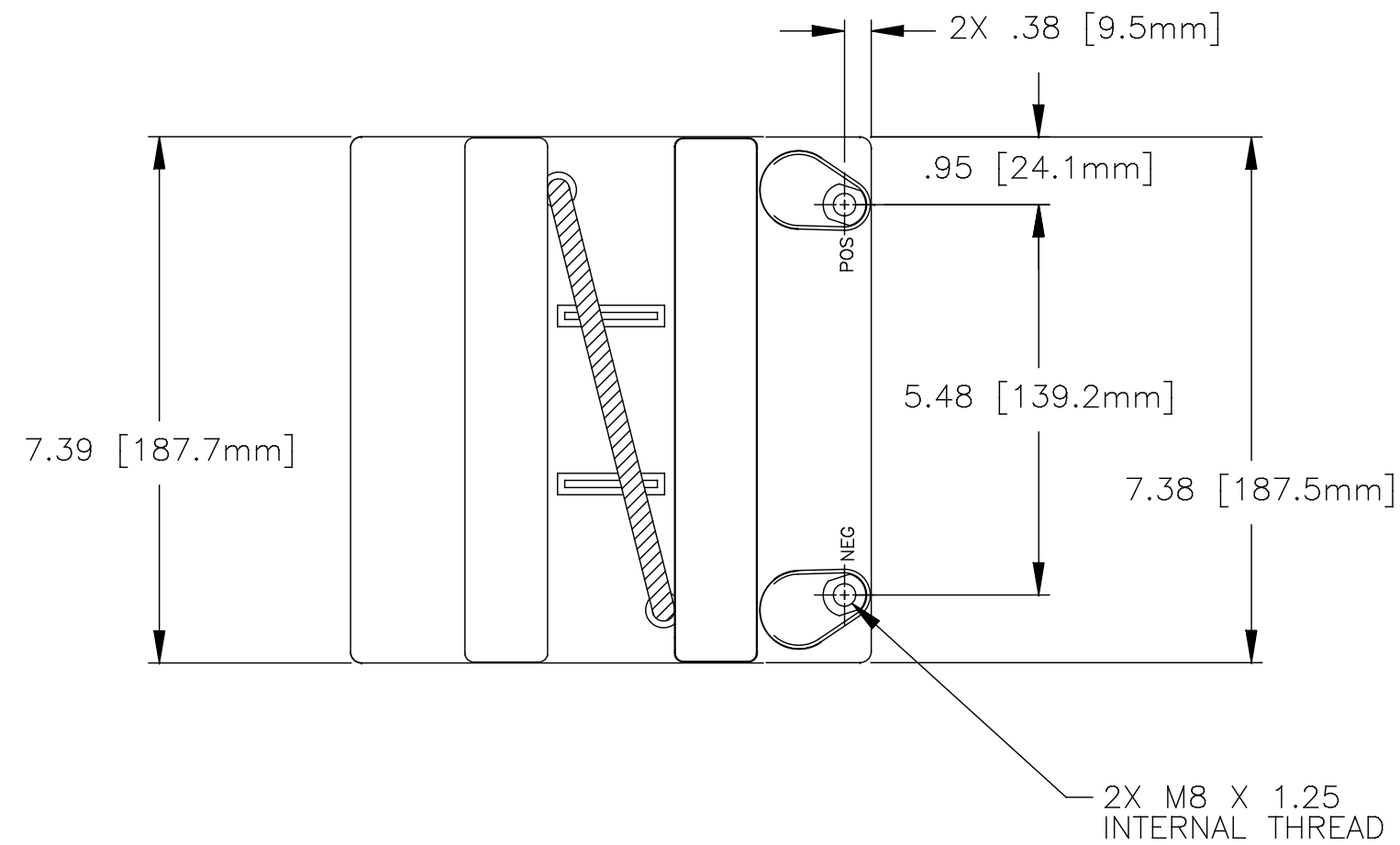

PART NUMBER	RG24-16
MAXIMUM WEIGHT	29.5 LBS [13.4 KG]
RATED CAPACITY, C <sub>1</sub>	13.6 AH
POWER RATING AT 23°C	lpp 850 A, lpr 600 A
POWER RATING AT -18°C	lpp 575 A, lpr 375 A
POWER RATING AT -30°C	lpp 450 A, lpr 350 A

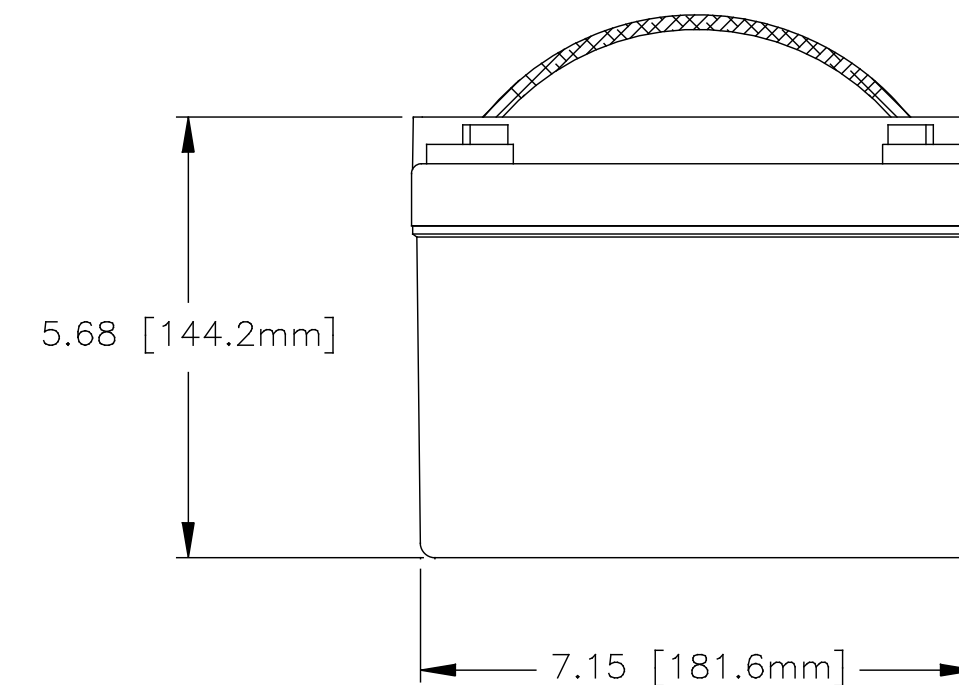
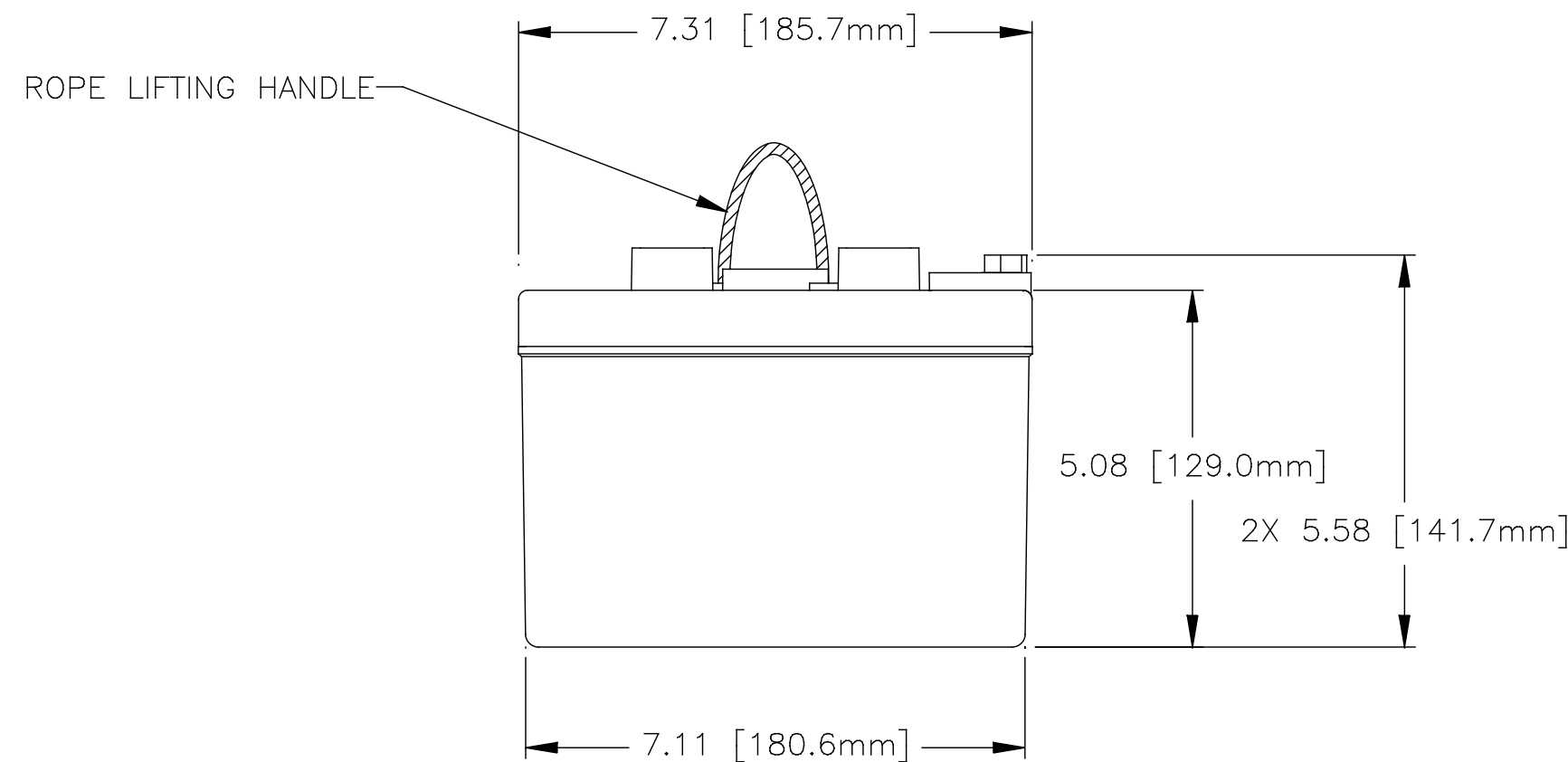

ENVELOPE DRAWING

QTY REQD	CAGE CODE	PART OR IDENTIFYING NO.	NOMENCLATURE OR DESCRIPTION	MATERIAL SPECIFICATION	ITEM NO.
PARTS LIST					
UNLESS OTHERWISE SPECIFIED DIMENSIONS ARE IN INCHES TOLERANCES ARE: FRACTIONS    DECIMALS    ANGLES .XX ± .06 .XXX ± .060			CONTRACT NO.		
TREATMENT    NONE			CONCORDE BATTERY CORPORATION 2009 SAN BERNARDINO RD, W. COVINA, CA 91790		
FINISH    NONE			TITLE BATTERY, VRSLA, 24 VOLT		
SIMILAR TO			APPROVALS    DATE DRAWN    JBT    1/25/06 CHECKED    AMIII    1/25/06 APPROVED    JBT    1/25/06 ISSUED    JJ    10/6/10		
ACT WT		CALC WT		SIZE    CAGE CODE    DWG NO.    REV C    63017    RG24-16    B	
SCALE    NONE				SHEET    1    OF    1	